

3X2 Single External Pilot Operated Valve

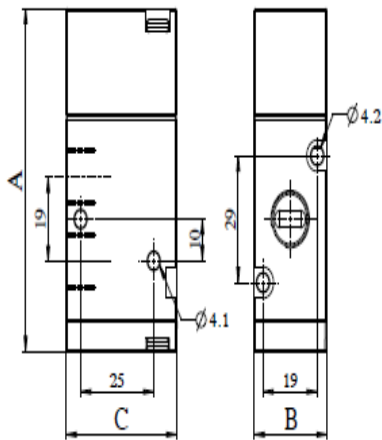

Technical Data

A 3/2 single external pilot with spring return valve is a type of standard mechanical valve that are activated by external pilot pressure. In standard industrial applications, they have been used where pressure is supplied to an external port to switch the main valve.

Normally open and normally closed are the two variants available in 3/2 single external pilot valves. Namur type is also available which are directly mounted on pneumatic actuators.

Design features and materials

Aluminum parts	Aluminum alloy
Steel Parts	Steel with surface treatment
Springs	Spring steel with surface treatment or S.S.
Plastic parts	POM, PA, Nylon
Sealing elements	Nitrile rubber

Circuit function

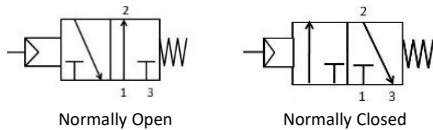

Model	32
Design	Spool type
Medium	Compressed air- Dry, filtered, Lubricated
Working Pressure range	2-10 Bar
External Pilot pressure	2-4 Bar
Recommended oil for lubrication	ISO VG32(Servo system 32)
Ambient/Medium temperature	5°-60°C
Flow	Inlet & Outlet Port-
	G 1/8" - 774 LPM@10 bar
	G 1/4" - 1000 LPM @ 10 bar
	G 1/2" - 2930 LPM @ 10 bar
Packaging Dimensions(mm)	Inlet & Outlet Port - A / B / C
	G1/4" -79 / 25 / 38
	G1/2" -96 / 50 / 38
	G1/8"- 79 / 25 / 38

32S

18

P1

O

0

Code	Inlet/Outlet Port
18.....	G 1/8"
14.....	G 1/4"
12.....	G 1/2"

Exhaust Port
G 1/8"
G 1/8"
G 1/2"

Code	Function
P1.....	Single External Pilot with spring return

Code	Function
O.....	Normally Open
C.....	Normally Closed

Code	Type
0.....	W/o Namur

Order Code:-

While ordering valve, please mention the suffix given above.

Example:-

The ordering no. for 3X2 Single external pilot normally open valve with port size G1/8" is **32S18P100**.