

3X2 Double External Pilot Operated Valve

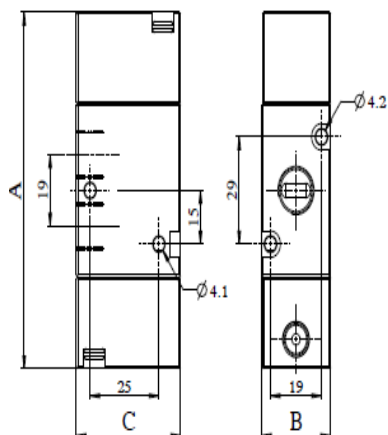

Technical Data

A 3/2 double external pilot is a type of standard mechanical valve that are activated by external pilot pressure. They find their application in pneumatic circuits where both the positions need to be controlled by external pilot pressure.

Normally open and normally closed are the two variants available in 3/2 double external pilot valves.

Namur type valves are available with both the outlet directly connected to the pneumatic actuators or with rotary actuators.

Design features and materials

Aluminum parts Aluminum alloy

Steel Parts Steel with surface treatment

Springs Spring steel with surface treatment or S.S.

Plastic parts POM, PA, Nylon

Sealing elements Nitrile rubber

Circuit function

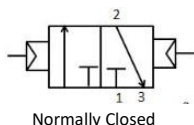
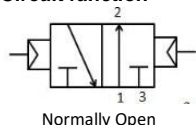

Model	32
Design	Spool type
Medium	Compressed air- Dry, filtered, Lubricated
Working Pressure range	2-10 Bar
External Pilot pressure	2-4 Bar
Recommended oil for lubrication	ISO VG32(Servo system 32)
Ambient/Medium temperature	5°-60°C
Flow	Inlet & Outlet Port-
	G 1/8" - 774 LPM @10 bar
	G 1/4" - 1000 LPM @10 bar
	G 1/2" - 2930 LPM @10 bar
Packaging Dimensions(mm)	Inlet & Outlet Port - A / B / C
	G1/4" - 97 / 25 / 38
	G1/2" - 114 / 50 / 38
	G1/8" - 97 / 25 / 38

32S

18

DX

O

0

Code	Inlet/Outlet Port	Exhaust Port
18.....	G 1/8"	G 1/8"
14.....	G 1/4"	G 1/8"
12.....	G 1/2"	G 1/2"

Code	Function
DX.....	Double External Pilot

Code	Function
O.....	Normally Open
C.....	Normally Closed

Code	Type
0.....	W/o Namur

Order Code:-

While ordering valve, please mention the suffix given above.

Example:-

The ordering no. for 3X2 Double external pilot normally open valve with port size G1/8" is **32S18DX00**.